



www.polinetlux.com
www.polinetltd.com.tr

Email: export@polinetlux.com
info@polinetltd.com.tr



Istanbul Office: +90 885 8500776

Kocaeli Fabric: +90 262 7281513

Professional Products and Systems for Translucent Roof and Facade Windows

The window and automation systems which complemente Polinet's roof& wall polycarbonate natural lighting systems, provide safe, aesthetic and functional solutions for the use of natural ventilation and smoke evacuation. Roof & facade window frame details, which consist of specially designed heat-insulated aluminium profiles according to Polinet's polycarbonate glazing systems, provide safe and compatible adaptation without risk of water exposure. Multi-wall polycarbonate panels can be easily installed into casement profiles of the windows. Roof & facade windows perform their opening and closing functions with electrical opening mechanisms. The electrical mechanisms of many windows can be grouped in order to perform their opening and closing functions all together and they are connected to one electronic control unit in the system automation. This system automation is be run with button or remote- control alternatives. Optional accessories for multifunctional automation such as smoke, rain, wind and alarm buttons are connected to the control units. The control units can also be integrated with existing general fire alarm systems.

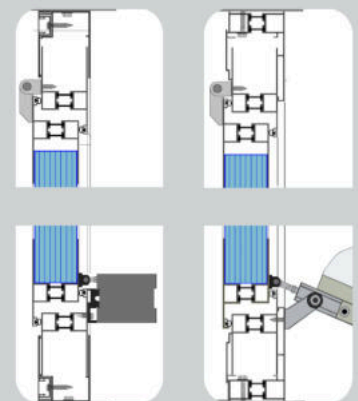
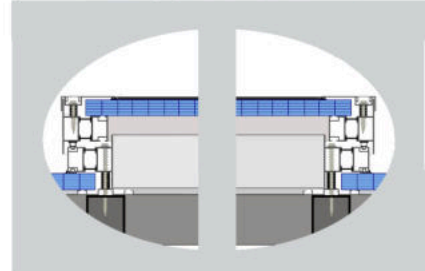

Ventilation and Smoke extraction / 24 or 230 V Alternative Motor / Control Units/ Smoke, Rain, Wind Sensors / Emergency Buton / Buton or Romote Control

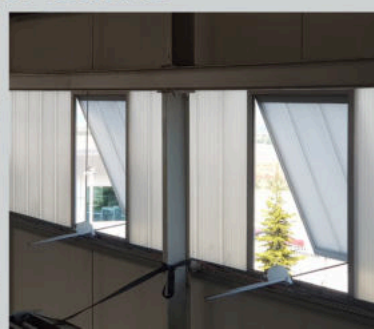
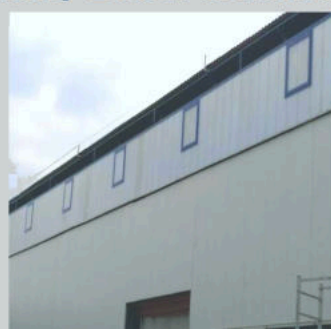

HORIZONTAL CROSS SECTION

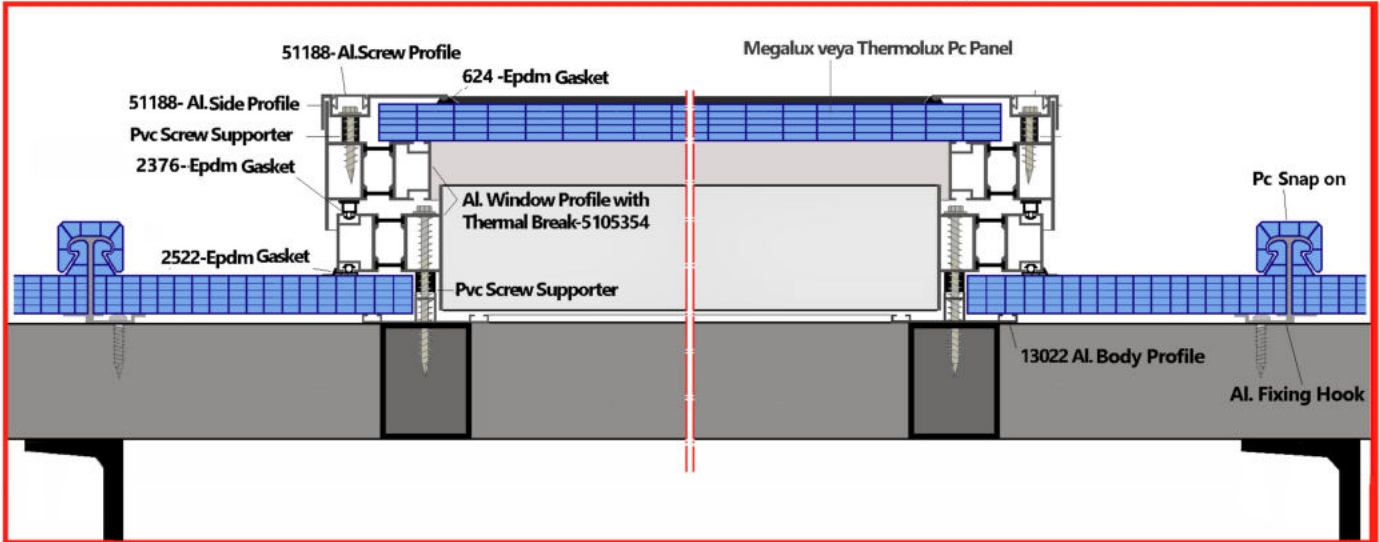

VERTICAL CROSS SECTION

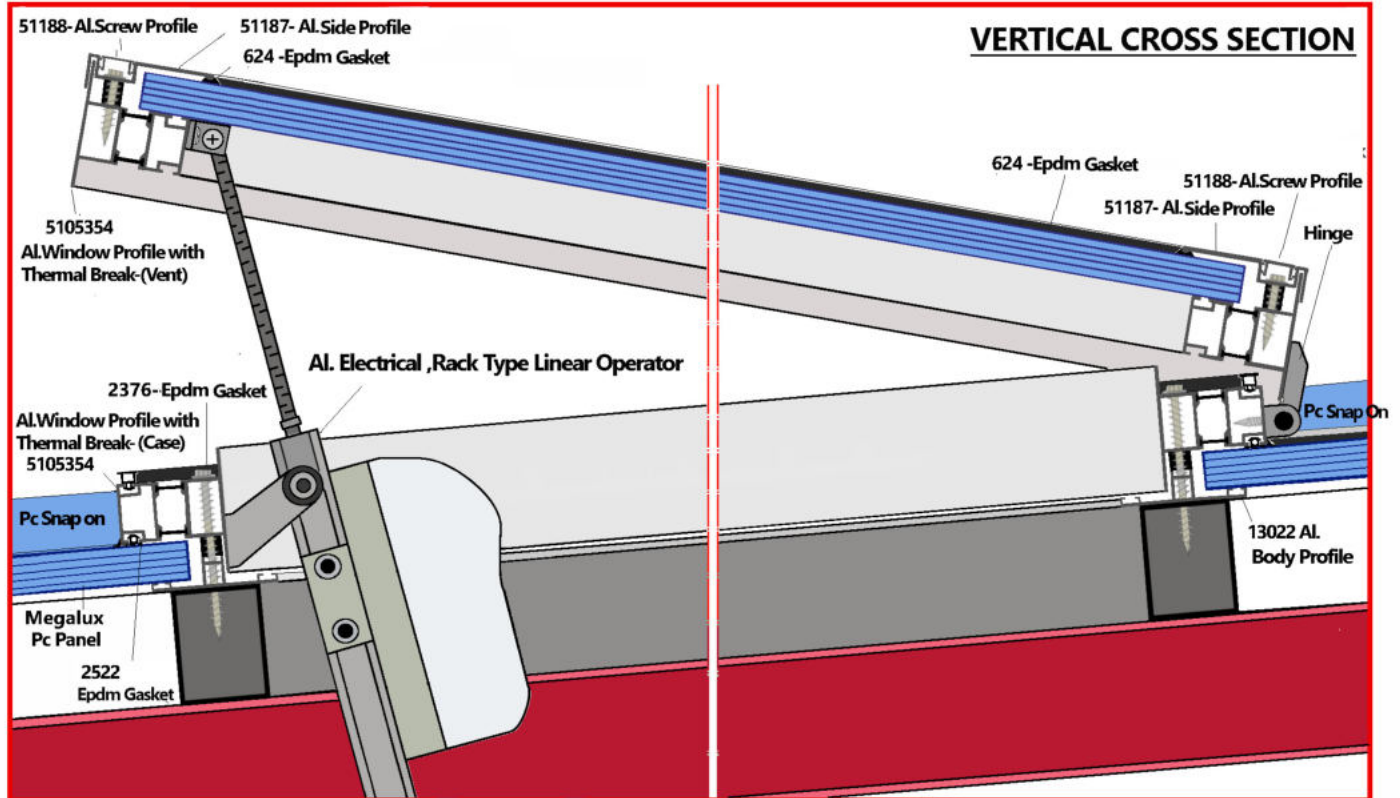

AUTOMATION SYSTEM PRODUCTS FOR THE ROOF WINDOW

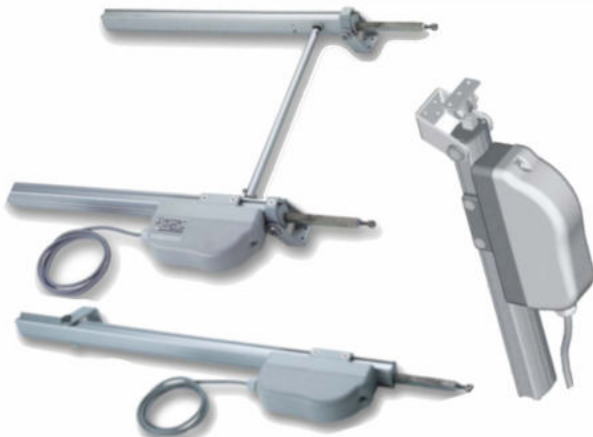

AL. Electrical ,Rack Type Linear Operator -24 or 230 V
l=55 and 75 cm



CONTROL UNITS -24 V& 220 V



CONTROL OPERATORS
Buton or Remote operator



OPTIONAL ACCESSORIES
Smoke-Rain-Wind

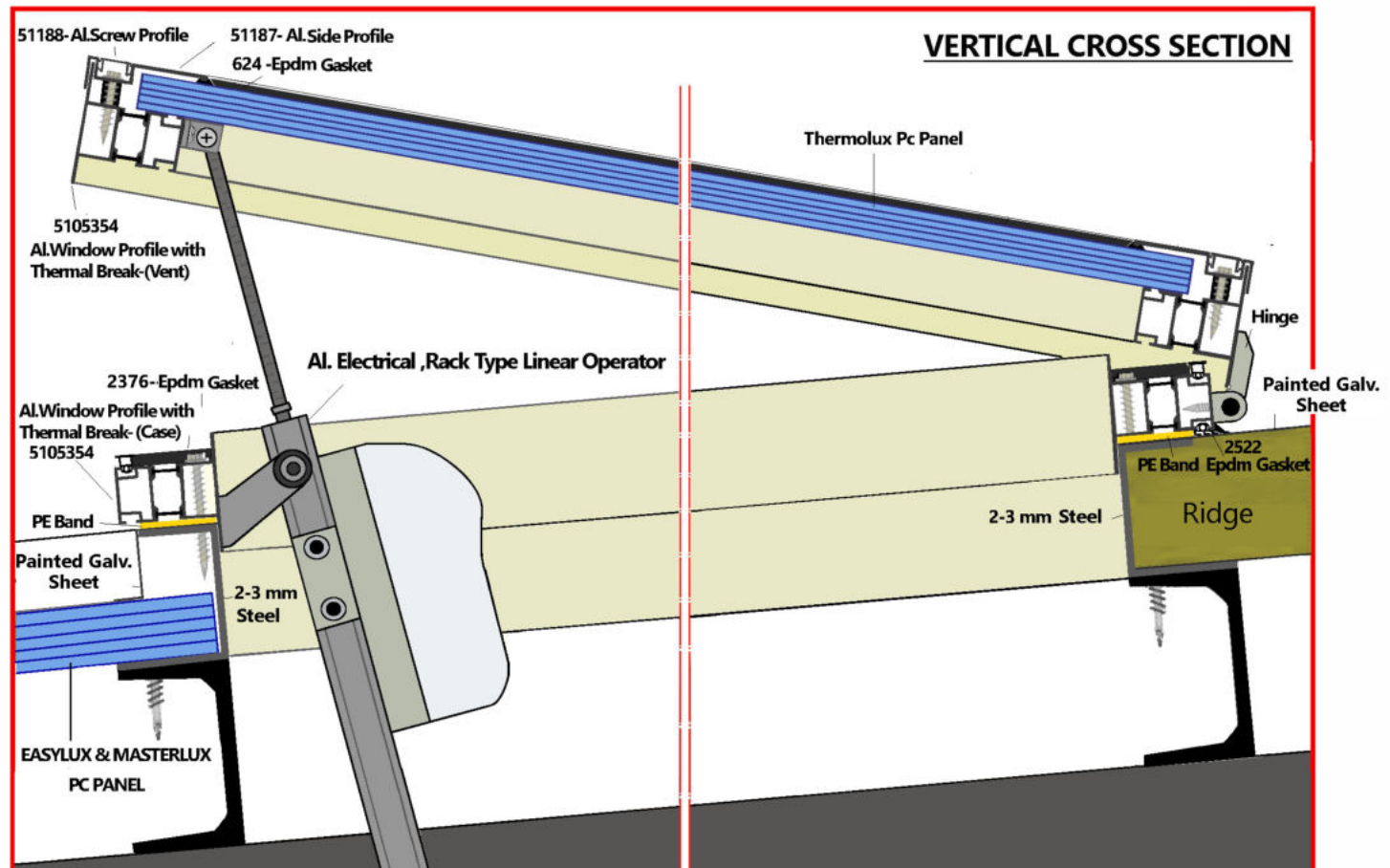
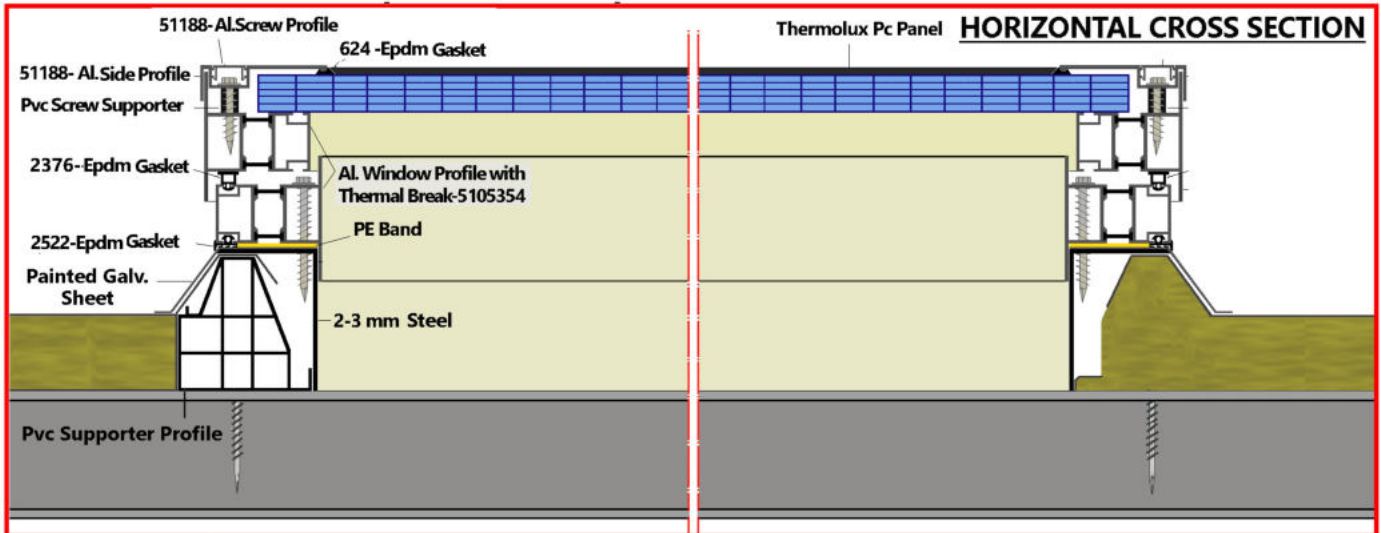

AUTOMATION SYSTEM PRODUCTS FOR THE ROOF WINDOW

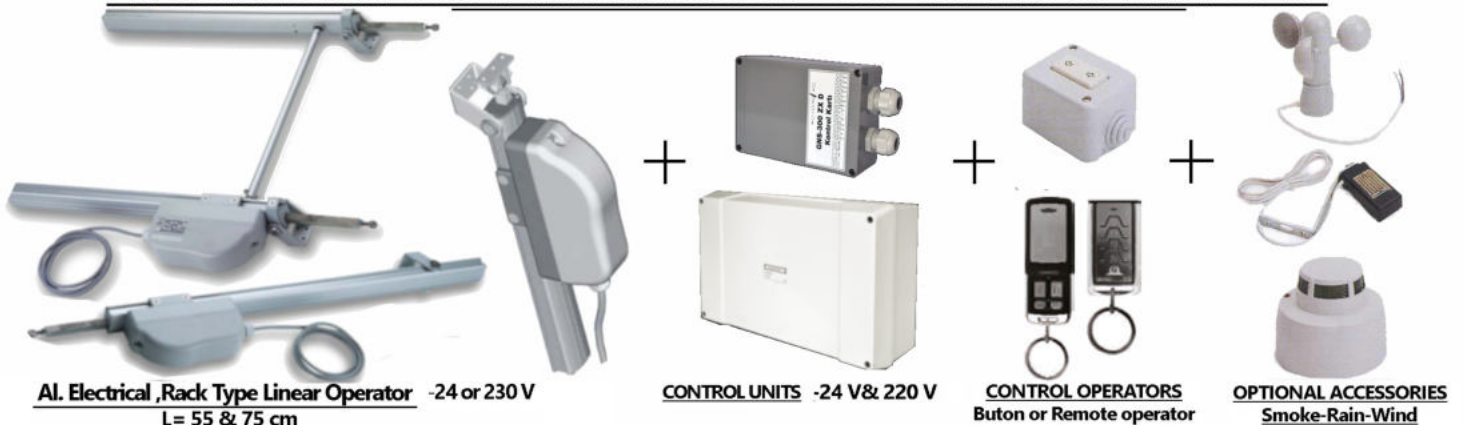

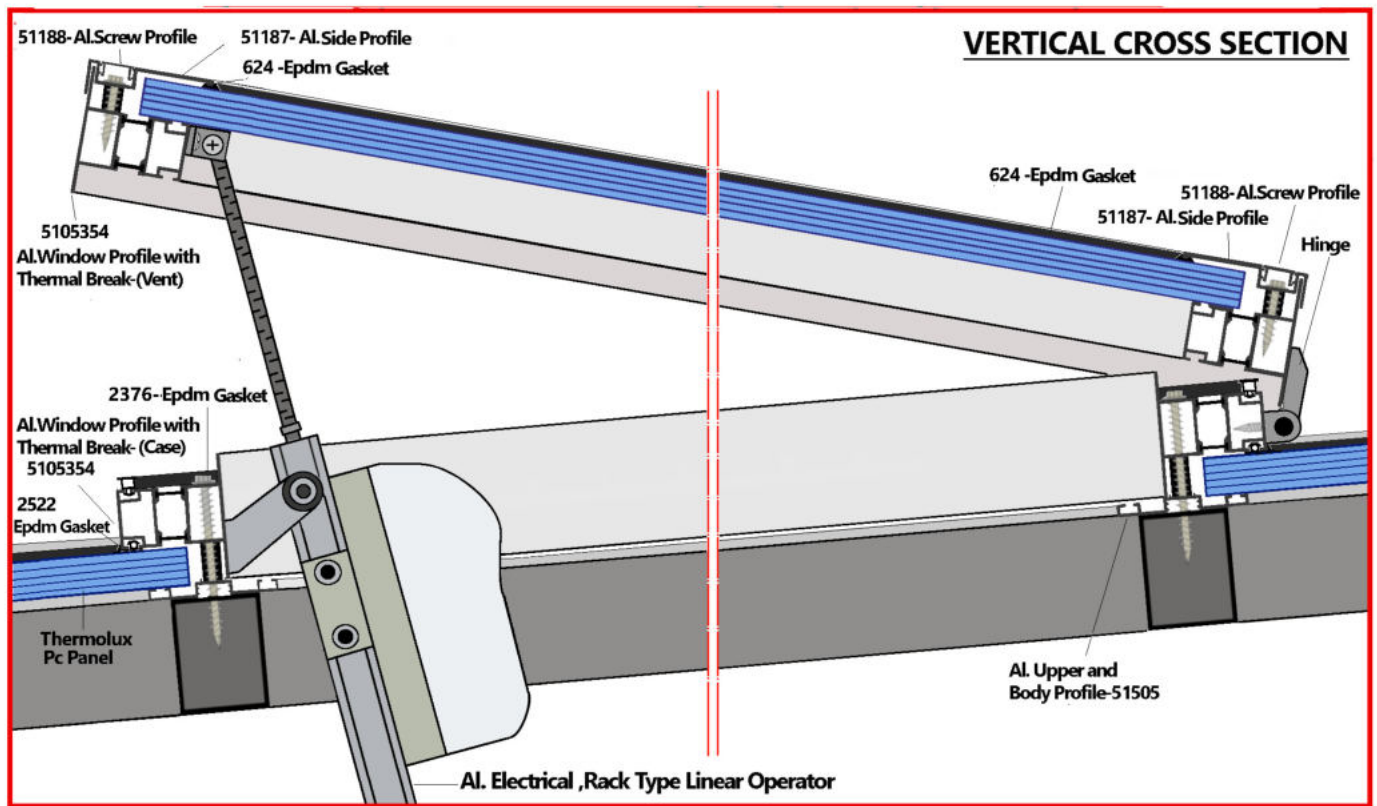
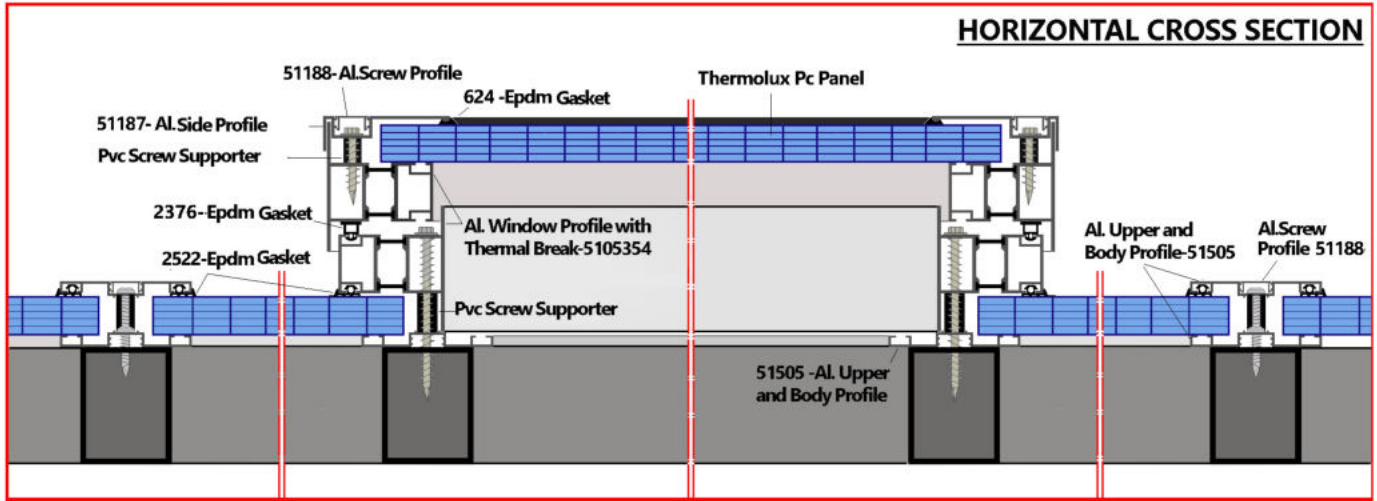

AUTOMATION SYSTEM PRODUCTS FOR THE ROOF WINDOW

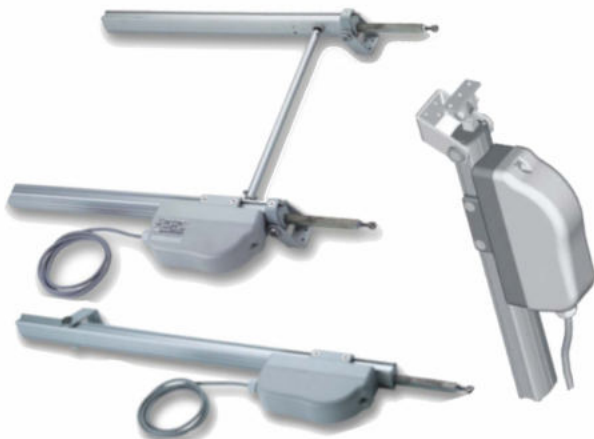

Al. Electrical ,Rack Type Linear Operator -24 or 230 V
L=55 and 75 cm

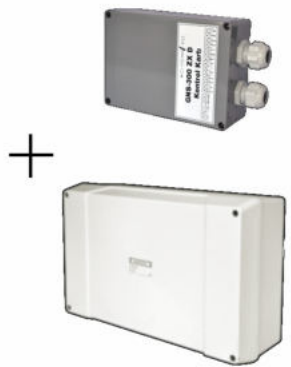

CONTROL UNITS -24 V& 220 V



CONTROL OPERATORS
Buton or Remote operator



OPTIONAL ACCESSORIES
Smoke-Rain-Wind

OUTWARD OPENABLE WINDOW AND AUTOMATION SYSTEM

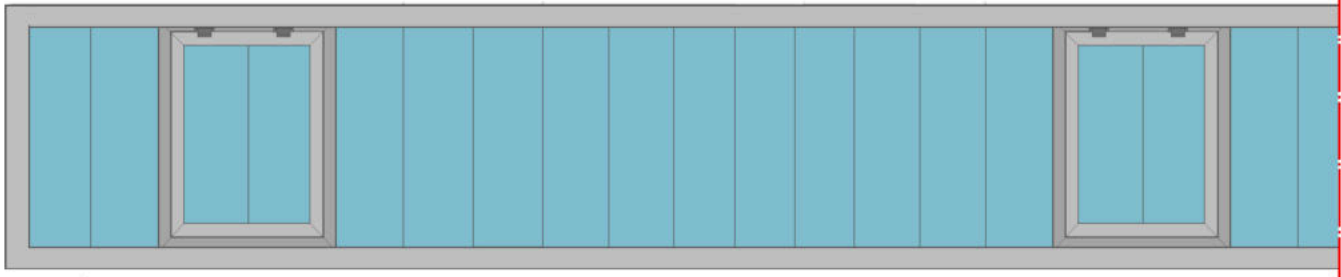
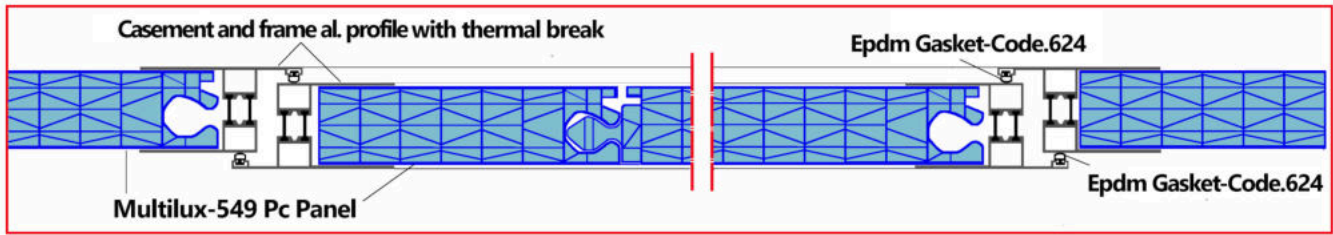

The window system is adapted easily and safely with Multilux pc panels because the aluminium frame of windows is compatible with the all frame aluminium profiles. Mechanisms of the opening are fixed on aluminium profiles to open towards outside.

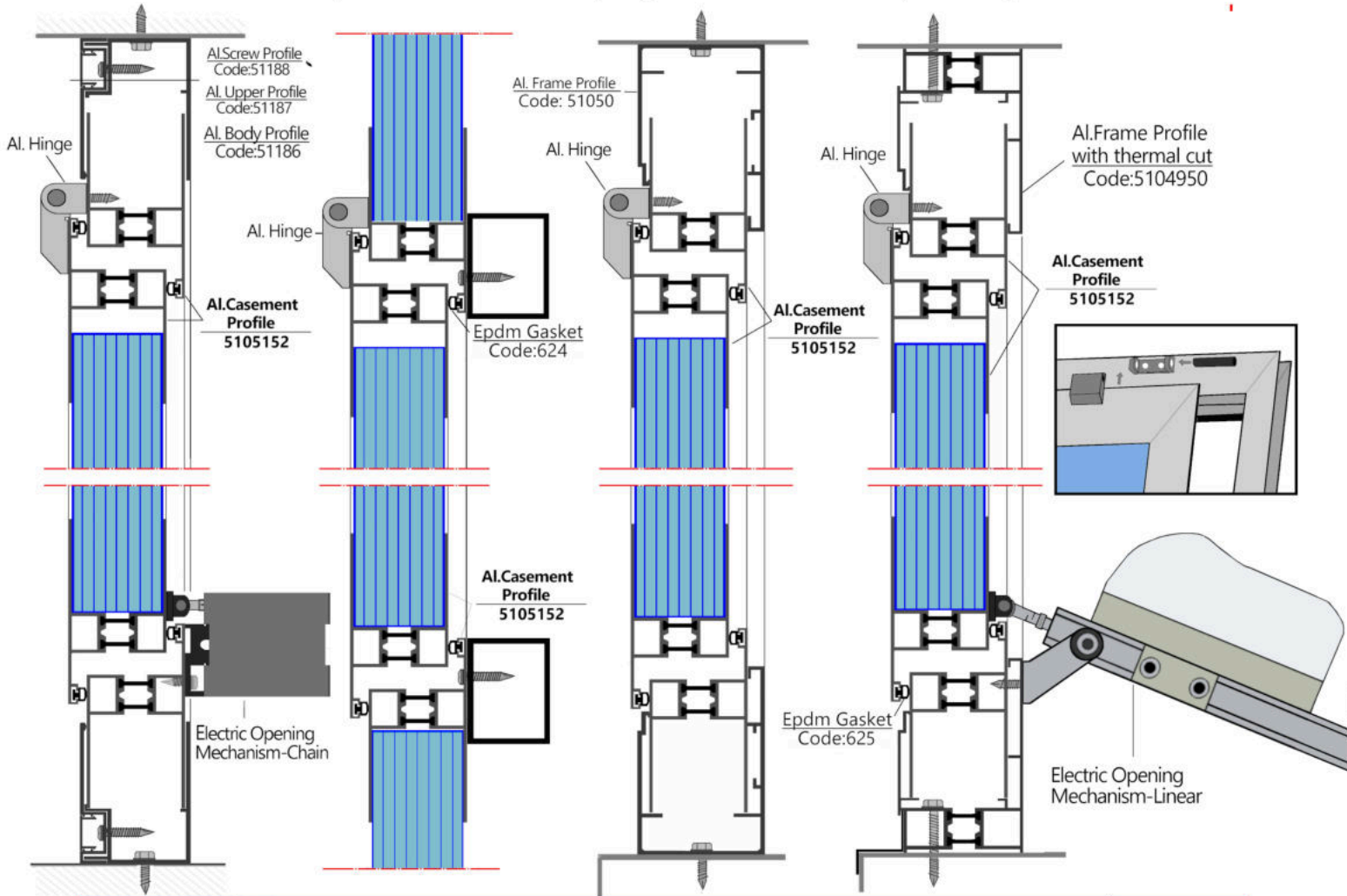

Electric Opening Mechanism-Chain

Electric Opening Mechanism- Linear

Control Units

Buton- Remote Control
Smoke -Rain- Smoke Sensors

AL.FRAME SYSTEM PROFILE SERIES AND CASEMENT PROFILE with THERMAL BREAK

This system can be adapted with sandwich panel of 40 mm thickness

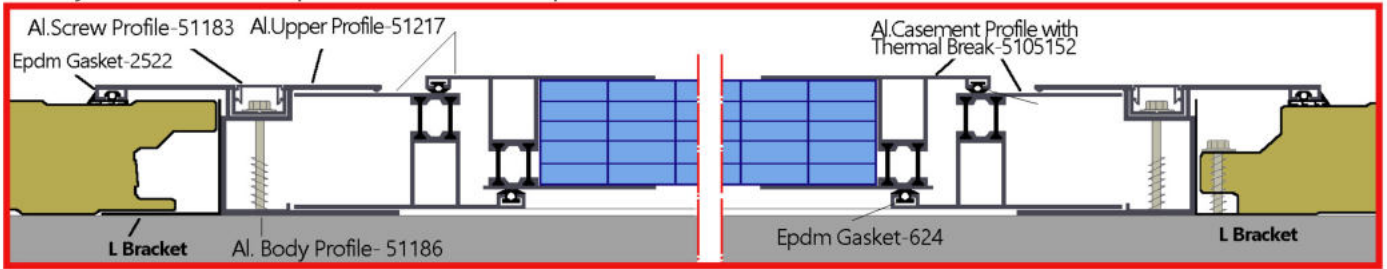

The window in the middle

The window on the top

The window in the down

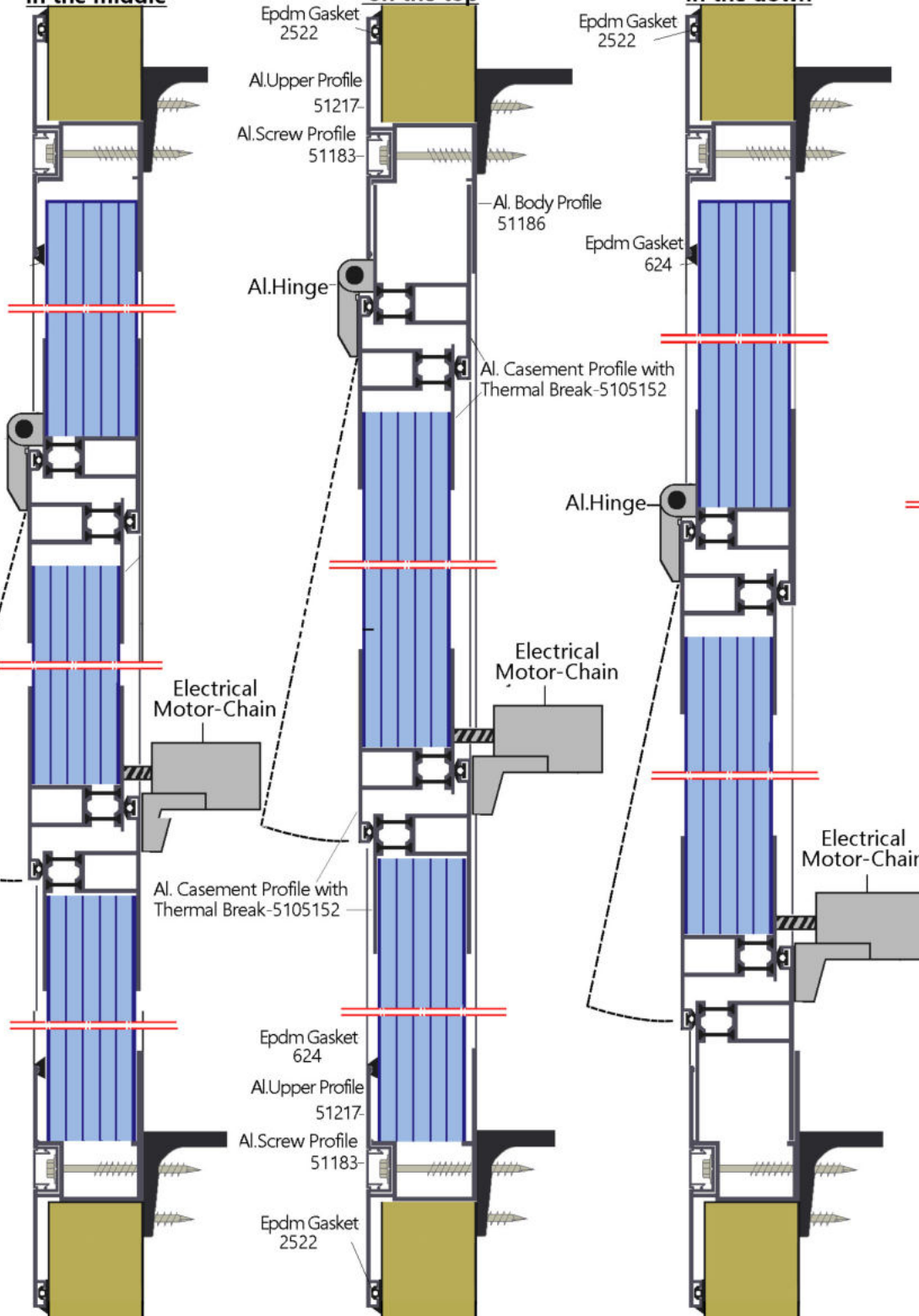
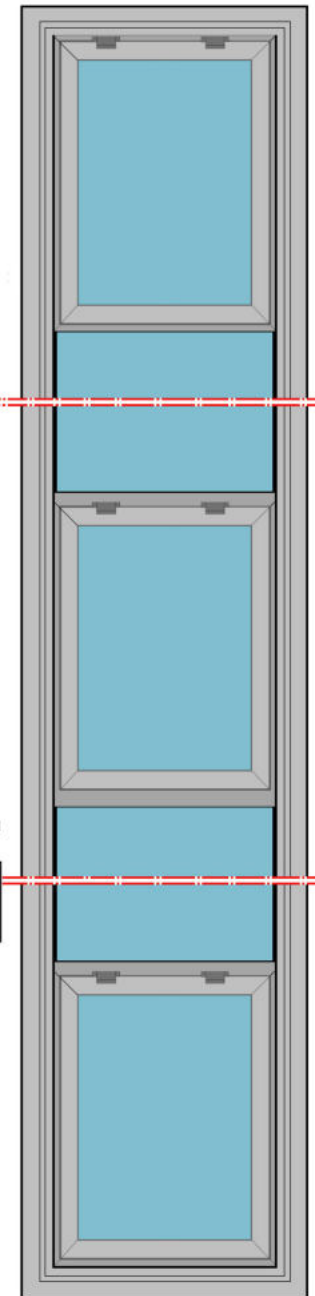
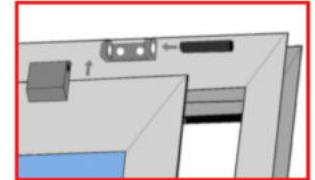

THERMAL BREAK FRAME&CASEMENT PROFILE SERIES

This system can be adapted with sandwich panel of min. 50 mm

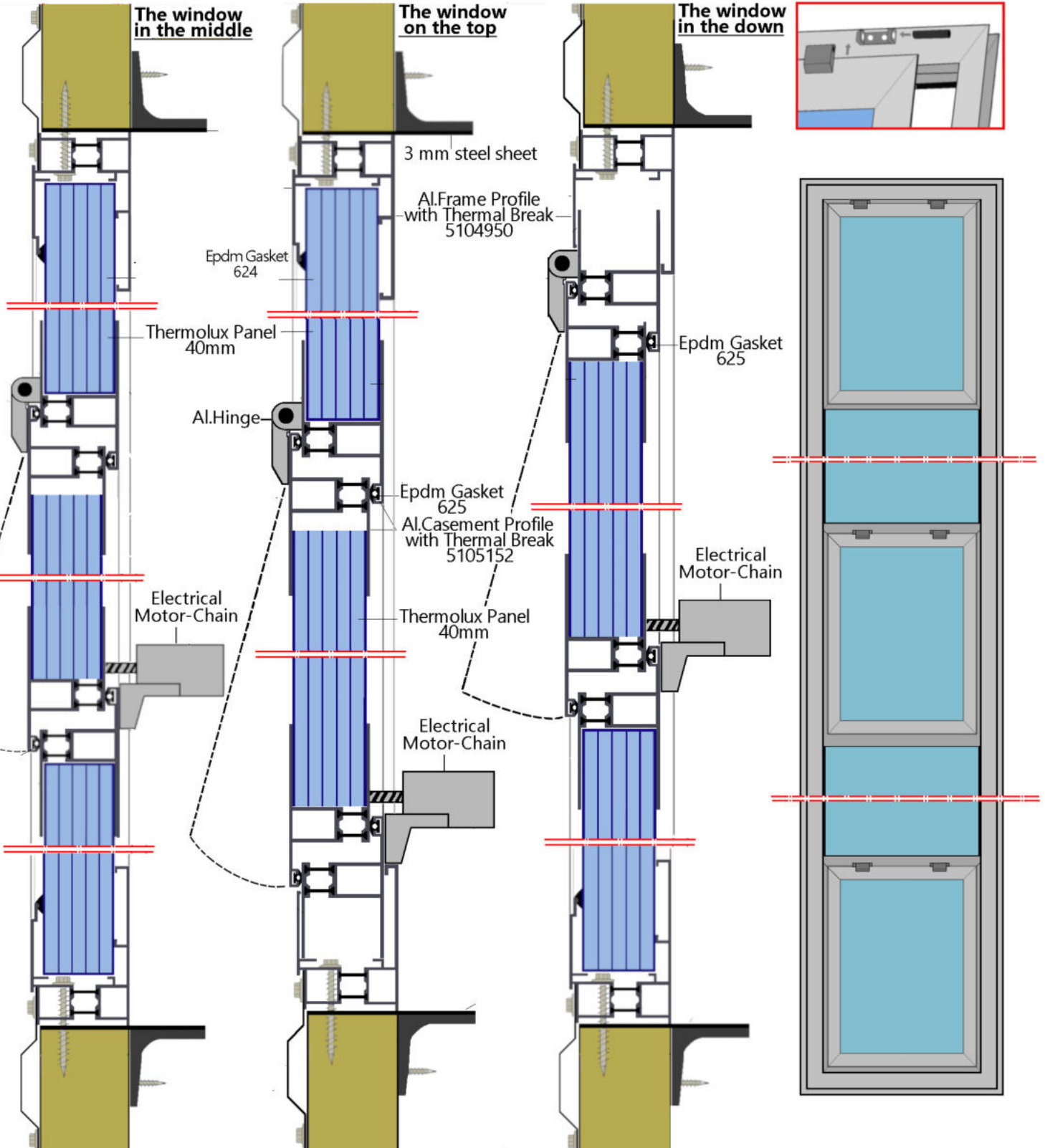
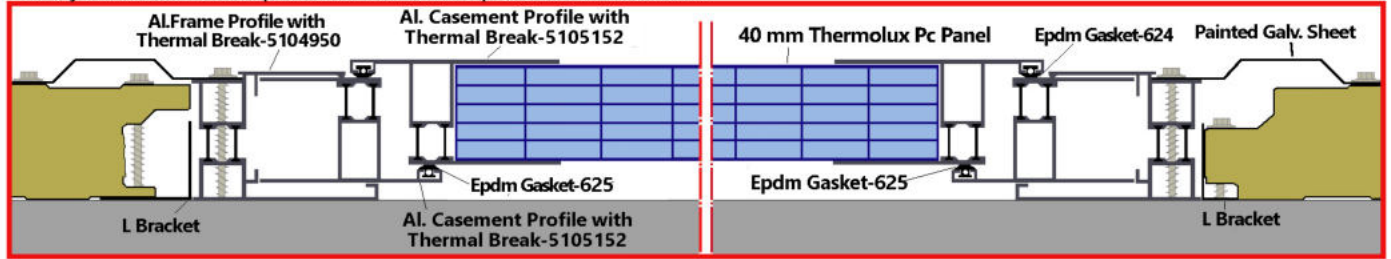

ELECTRICAL LINEAR OPERATORS

VOLTAGE	24 Vdc +/- 15%	230 Vac +/- 5%
THRUST AND PULL FORCE	800N (for strokes -550);650N (for strokes750 mm)	
STROKES AVAILABLE	550-750mm	
PARALLEL CONNECTION	Yes	
TRAVERSE SPEED (NO LOAD)	8 mm/sec.	
TRAVERSE SPEED AT FULL LOAD	6,5 mm/sec	
CURRENT	0,9 Ampere at full load	
CONSUMPTION	22 Watt	21 Watt

Aluminium,rack-type linear operator with an electronic limit-switch, IP 65 protection rating, available with a parallel connection and anti-interference filter on the electric motor.24 V cc motor with internal transformer for vers. 230 V ac complete with an anodized aluminium bracket and zinc-plated steel frame connection.The rack is of zinc-plated steel C43 , with squared section 12x12.Available The case is of Nylon PA 6,6, made up of two pieces with sealing gaskets.Set up for conversion to DUO or TRY system version (two or three thrust points)) made up of: drive units, bracket adapter ,operator support, steel drive connector.

ELECTRICAL CHAIN OPERATORS

VOLTAGE	24 Vdc +/- 15%	230 Vac +/- 5%
THRUST AND PULL FORCE	150 N/300 N	
STROKES AVAILABLE	from 90 to 400 mm*	
PARALLEL CONNECTION	Yes	
TRAVERSE SPEED	40 mm/sec.	
CURRENT	1.8 A DC	0.8 A
CONSUMPTION	40 Watt	150 Watt

Electro-mechanical chain operator with internal magazine in a nylon casing. Suitable for bottom-hung and outward opening windows, adjustable stroke from 90 to 400 mm. Fitted with limit switch. Fitted with removable terminal board for easy and practical electric connection and warning light to indicate frame closed. It is available in the 230 V AC and 24 V DC versions in the standard colours of BLACK, GREY, WHITE.RAL colours available on request.

ELECTRICAL OPERATORS

CONTROL UNITS

COMMAND EQUIPMENTS

OPTIONAL ACCESSORIES

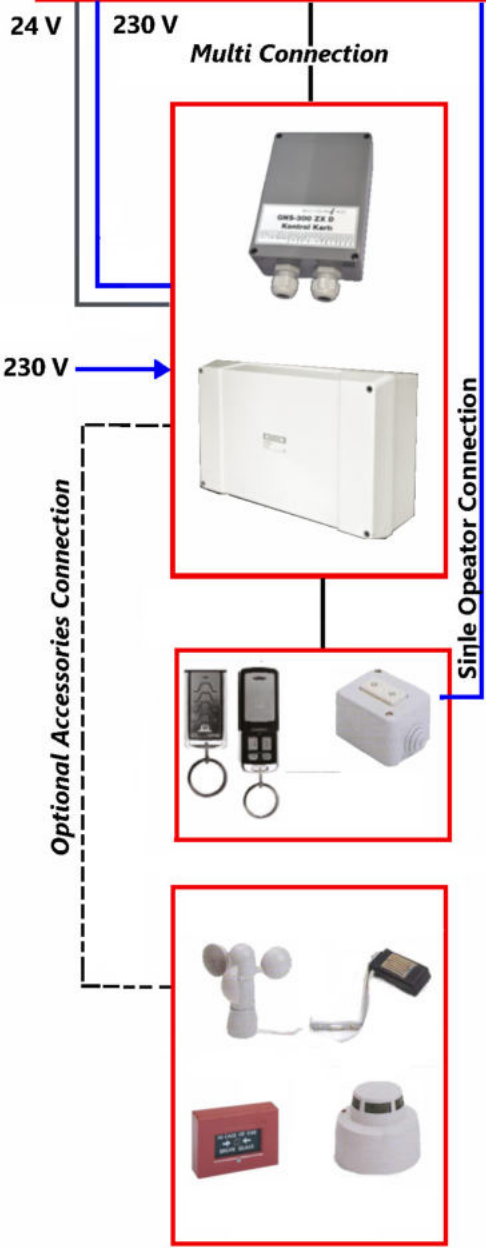

CONTROL UNIT FOR 220 V ELECTRICAL LINEAR OR CHAIN OPERATORS

- Max.10 pcs 220 V can be run by grouping the linear operators
- Ability to status reporting via Led signal . IP 65 degree of protection.
- Automatic shut-off function when rain and wind sensors are connected
- Automatic power-on function when the emergency button or smoke sensor is connected
- On Control via buton or remote contro
- Ability paralel connection among the control units
- Ability to integrate into the building fire alarm system

CONTROL UNIT FOR 24 V ELECTRICAL LINEAR OR CHAIN OPERATORS

- Max.9 pcs 24 V linear operators can be run by grouping the linear operators
- Max. 6 pcs 24 V chain operators can be run by grouping the linear operators
- Ability to status reporting via Led signal . IP 65 degree of protection.
- Automatic shut-off function when rain and wind sensors are connected
- Automatic power-on function when the emergency button or smoke sensor is connected
- On Control via buton or remote contro
- Ability paralel connection among the control units
- Ability to integrate into the building fire alarm system

*The control units via higher capacity than the above-mentioned control unite can be produced for special project inseed of paralel connection among the control units

BUTON

It performs opening and closing functions of the control units and single linear or chain operators 220V

ROMOTE CONTROL

They have two or for channel alternatives so they can control two or four control units.

WIND DETECTOR

The Wind Detector that connects to the Control Unit is activated in windy weather and enables the operators to close automaticallythe windows.

RAIN SENSOR

Rain detector that connects to the Control Unit is activated in rainy weather and enables the operators to close automatically the windows.It is fitted with an automatic heating unit which is activated when the detection plate is wet.

SMOKE DETECTOR

Optical smoke detector with self-adjusting actuation threshold. Conforms to EN 54 Operating voltage: from 12 to 24 V DC

EMERGENCY CONTROL UNIT

control unit triggered automatically when the glass is broken.The unit is fitted with NO and NC contacts. Red wall-mounting container.